

# MOTION PICTURE MINIATURES

[www.motionpictureminiatures.com](http://www.motionpictureminiatures.com)

The following instructions are only intended to be a very basic guide for assembly. The builder is encouraged to use their own best judgment on how to approach the assembly of the parts, depending on their own specific goals for their project.

- 1 - Measure and mark the centre line along the length of the nacelle.
- 2 - Temporarily attach the template as shown, aligning nacelle and template centre line markings. Ensure the recesses are centred inside the upper box.
- 3 - Mark the larger cut-out on the nacelle using a pen or pencil

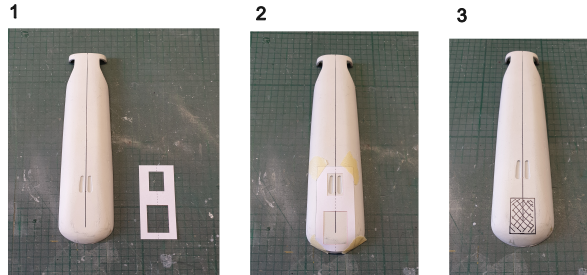

Carefully remove the marked material. Use files and sanding sticks to refine the shape until the replacement part fits cleanly.

Fill and sand any gaps and seams as necessary.

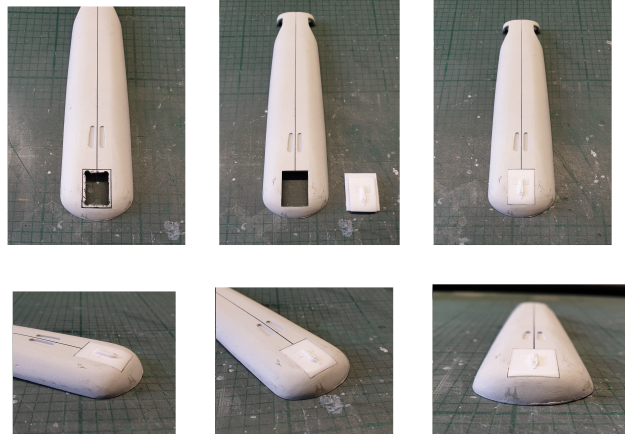

**Alignment templates**

**Cut out boxes indicated in red**

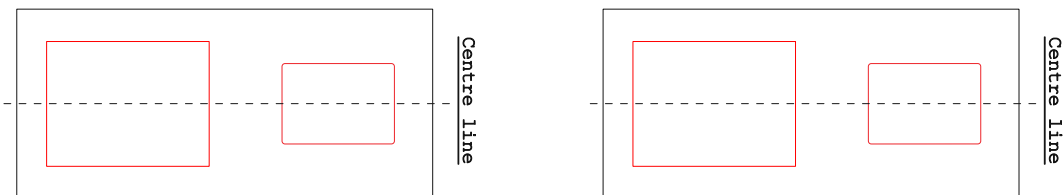

[www.facebook.com/mpminiatures](https://www.facebook.com/mpminiatures)